

Pola

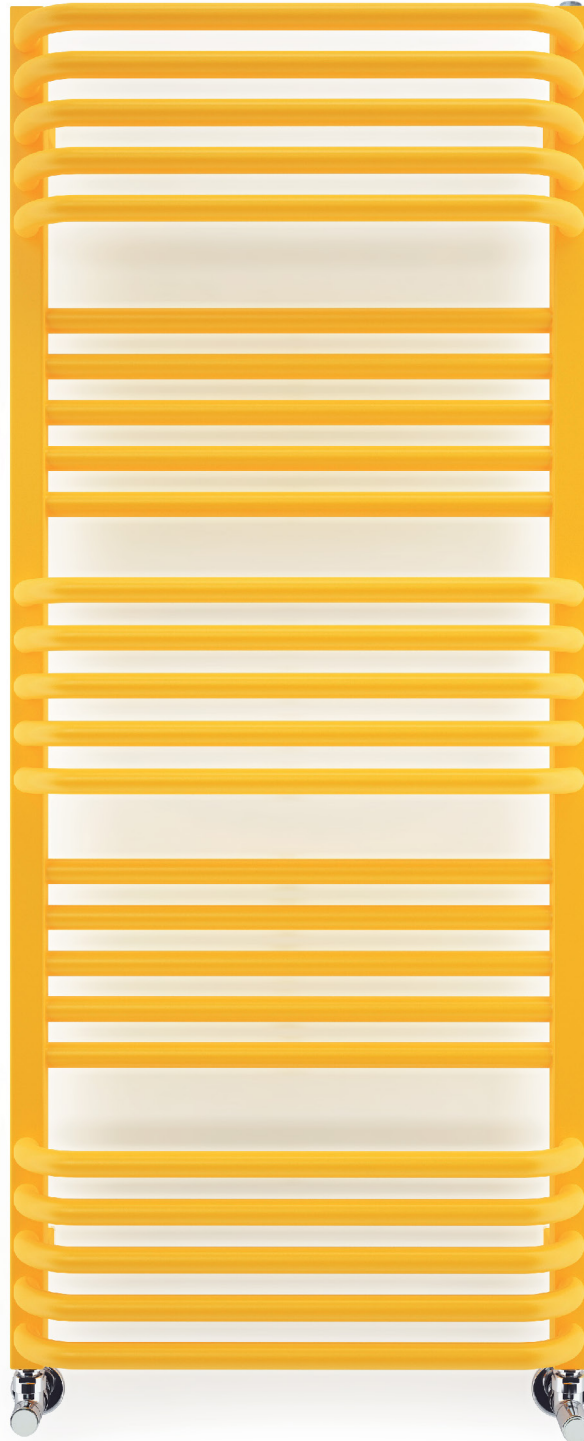

Colour included
in the price



Pola 1180 x 500
colour: RAL 1033

Angled lockshield valve, chrome
Angled regulating valve, chrome

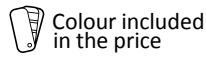

Connections:



Electric radiators:

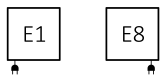

We recommend:

A set of integrated thermostatic valves for Z1 and Z8 connections



KTX 3 heating element



Available sizes:

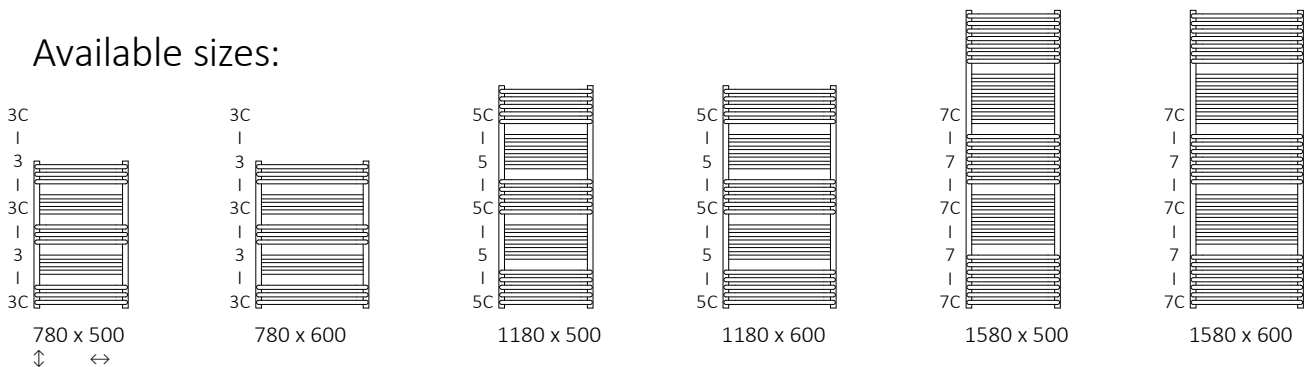

Specifications:

Working pressure: 1,0 MPa Maximum operating temperature: 95°C

A	B	C1	C2	75/65/20°C	55/45/20°C	☺	D	E	F	∪	⚖	Product Code
↓	↔	[mm]	[mm]	[W]	[W]	[W]	[mm]	[mm]	[mm]	[dm³]	[kg]	Configuration codes: 4
Powder coating												
780	500	50	470	392	211	400	470	600	90	3,34	6,72	WGPAL078050
780	600	50	570	471	254	400	570	600	90	3,79	7,68	WGPAL078060
1180	500	50	470	638	342	600	470	1000	90	5,39	10,84	WGPAL118050
1180	600	50	570	766	411	800	570	1000	90	6,14	12,44	WGPAL118060
1580	500	50	470	883	473	800	470	1400	90	7,44	14,96	WGPAL158050
1580	600	50	570	1061	568	1000	570	1400	90	8,49	17,20	WGPAL158060
Plated finishes												
780	500	50	470	274	140	300	470	600	90	3,34	6,72	WGPAL078050
780	600	50	570	330	168	300	570	600	90	3,79	7,68	WGPAL078060
1180	500	50	470	447	228	400	470	1000	90	5,39	10,84	WGPAL118050
1180	600	50	570	536	273	600	570	1000	90	6,14	12,44	WGPAL118060
1580	500	50	470	618	315	600	470	1400	90	7,44	14,96	WGPAL158050
1580	600	50	570	743	379	800	570	1400	90	8,49	17,20	WGPAL158060



Colour included in the price

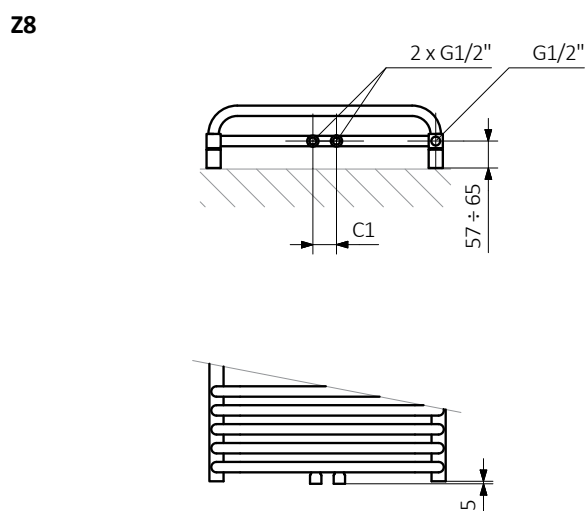
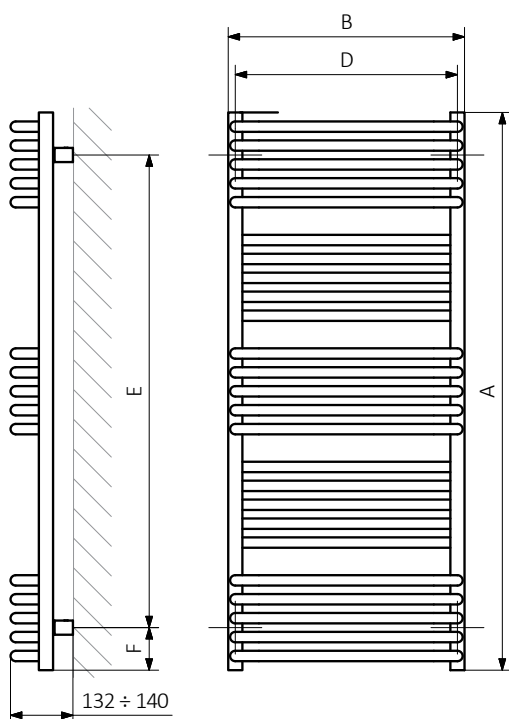
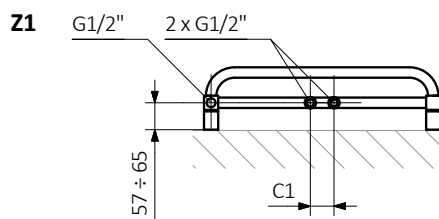
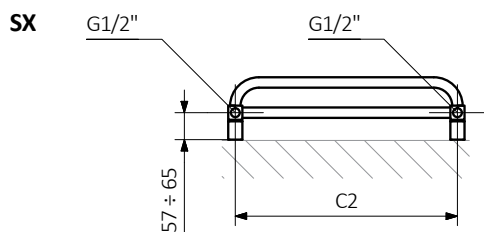

A — Height B — Width C1-C5 — Distance between pipe centres D — Horizontal distance between mounting bracket centres
E — Vertical distance between mounting brackets F — Distance between a mounting bracket and the bottom of the radiator

Collector:

Profile:

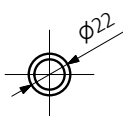
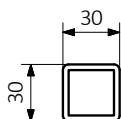

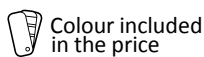

Product codes can be found in product data sheet tables. The codes provide some basic information about the product while a partially filled configuration code contains complementary information about the detailed specifications. When placing an order, product codes should include the fully completed configuration part. The configuration code part should be placed after the main product code. The main product code and configuration part will appear as shown in the example below:

The construction of a water and dual fuel radiator product and configuration code:

WGALE054030

K916SX

PRODUCT CODE
(located in the table for the product)

CONFIGURATION CODE
(supplemented by hand)

Configuration

K **916** **SX**

Package code Colour code Connection code
K – carton box

Construction of electric heater configuration code

WLALE054030

K916E1DRYM

PRODUCT CODE
(located in the table for the product)

CONFIGURATION CODE
(supplemented by hand)

Configuration

K **916** **E1** **DRY** **M**

Package code Colour code Connection code Heating element code Type of heating element cable code
K – carton box

Zinc powder primer

C – Code of zinc powder primer is an extra processes

WLALE054030 K916SX **C** — *Extra processes or additions code*

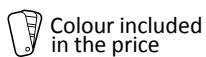

Legend



Available in chrome finish.



Radiator available in a "water" version.



Radiator suitable for dual fuel connection. Electric heating element can be installed.



Radiator available in electric only version. It comes prefilled with a 'heating medium' and equipped with a heating element. All tested and ready to use.



Connection types dedicated for this radiator.
The icon shows the flow and return connections for the radiator as well as the thermostatic valve and heating element position if applicable.



Optional connections available for this radiator.



Suggested heating element power output for electric and dual fuel versions.



Weight.



Capacity.