

Triga ANC



Colour included
in the price



Triga ANC 1700 x 280
colour: RAL 5024

Integrated thermostatic valve with immersion tube, angled, right, chrome
SLIM thermostatic head, chrome
Integrated pipe-masking set, chrome



Connections:



We recommend:

A set of integrated thermostatic
valves for YL and YP connections



Integrated
pipe-masking set



ZIP V hanger



Available sizes:

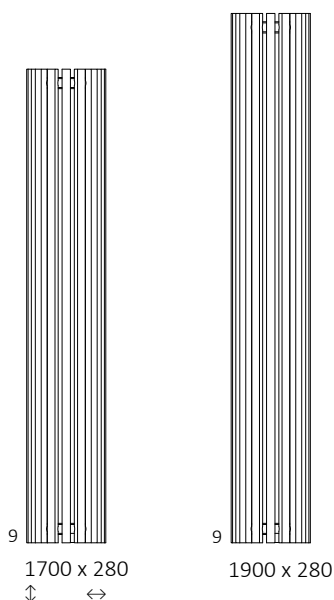

Specifications:

Working pressure: 1,0 MPa Maximum operating temperature: 95°C

A ↑	B ↔	C1 [mm]	75/65/20°C [W]	55/45/20°C [W]	[W]	D [mm]	E [mm]	F [mm]	[dm³]	[kg]	Product Code	Configuration codes: 4
1700	280	50	953	492	1000	151	1600	50	11,64	21,86	WGVEC170028	
1900	280	50	1053	548	1000	151	1800	50	12,95	24,19	WGVEC190028	

Triga ANC



Colour included
in the price

YP

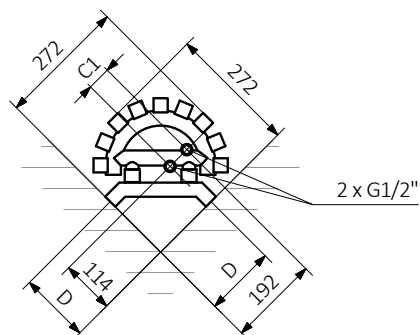

YL

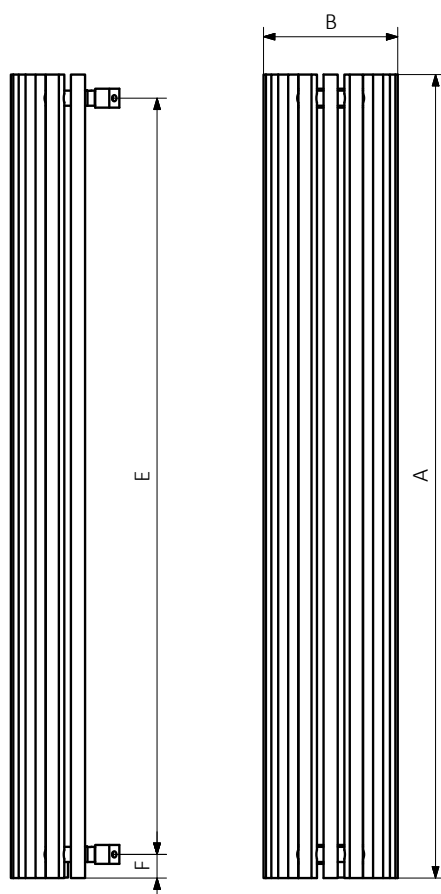
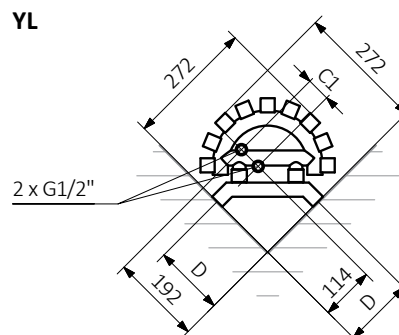

A — Height B — Width C1-C5 — Distance between pipe centres D — Horizontal distance between mounting bracket centres
E — Vertical distance between mounting brackets F — Distance between a mounting bracket and the bottom of the radiator

Collector:

Profile:

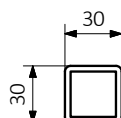
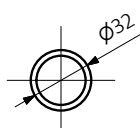



Product codes can be found in product data sheet tables. The codes provide some basic information about the product while a partially filled configuration code contains complementary information about the detailed specifications. When placing an order, product codes should include the fully completed configuration part. The configuration code part should be placed after the main product code. The main product code and configuration part will appear as shown in the example below:

The construction of a water radiator product and configuration code:

WGALE054030

PRODUCT CODE
(located in the table for the product)

K916SX

CONFIGURATION CODE
(supplemented by hand)

Configuration

K 916 SX

Package code Colour code Connection code
K – carton box

Zinc powder primer

C – Code of zinc powder primer is an extra processes

WLALE054030 K916SX **C** — *Extra processes or additions code*



Colour included
in the price

Legend



Available in chrome finish.



Radiator available in a “water” version.



Radiator suitable for dual fuel connection. Electric heating element can be installed.



Radiator available in electric only version. It comes prefilled with a ‘heating medium’ and equipped with a heating element. All tested and ready to use.



Connection types dedicated for this radiator.

The icon shows the flow and return connections for the radiator as well as the thermo-static valve and heating element position if applicable.



Optional connections available for this radiator.



Suggested heating element power output for electric and dual fuel versions.



Weight.



Capacity.