

Delfin

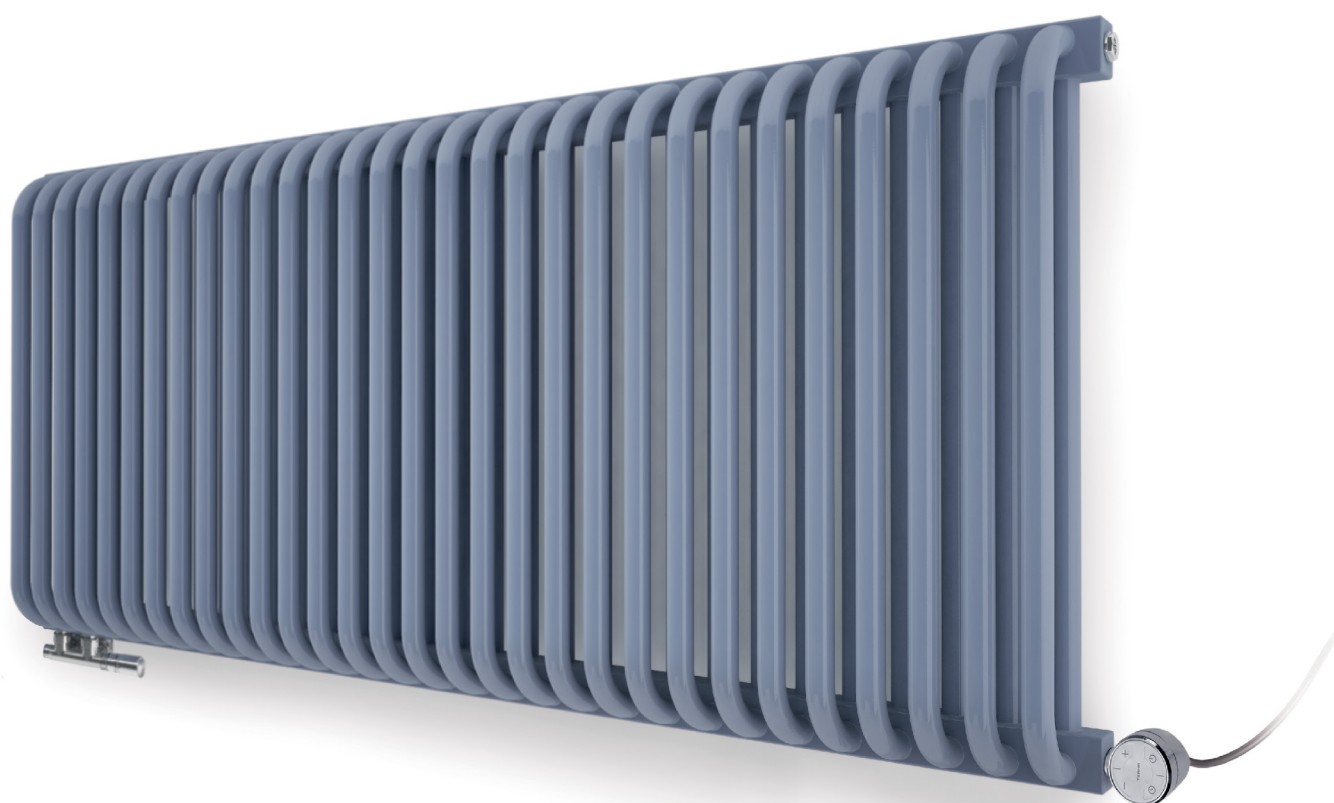

Colour included
in the price



Delfin 540 x 1220
colour: RAL 5023

Integrated thermostatic valve, angled, left, chrome
SLIM thermostatic head, chrome
Integrated pipe-masking set, chrome
MOA heating element



Colour included in the price

design: Terma

Connections:

A ↓ 440÷2000:

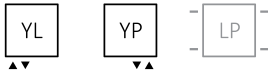

A ↓ 440÷640

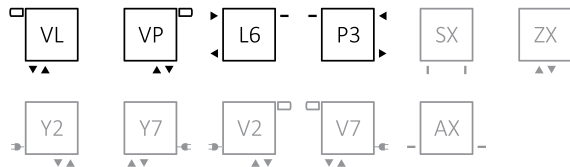

A ↓ 1800÷2000

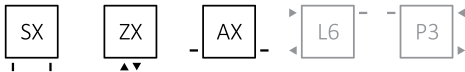

Electric radiators:(A ↓ 440÷640):



We recommend:

Integrated lockshield valve set for VL and VP connections



Integrated pipe-masking set

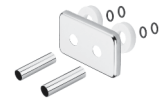

Specifications:

Configuration codes: <?>

Working pressure: 0,8 MPa Maximum operating temperature: 95°C

A ↓	B ↔	C1 [mm]	C2 [mm]	C3 [mm]	C4 [mm]	75/65/20°C [W]	55/45/20°C [W]	☼ [W]	D [mm]	E [mm]	F [mm]	∪ [dm³]	📦 [kg]	Product Code	Configuration codes: ?
440	820	50	-	400	-	705	370	800	710	400	21	6,41	13,76	WGDLF044082	
440	1020	50	-	400	-	885	465	800	910	400	21	8,01	17,15	WGDLF044102	
440	1220	50	-	400	-	1061	556	1000	1110	400	21	9,60	20,54	WGDLF044122	
540	820	50	-	500	-	846	442	800	710	500	21	7,61	16,32	WGDLF054082	
540	1020	50	-	500	-	1057	552	1000	910	500	21	9,50	20,35	WGDLF054102	
540	1220	50	-	500	-	1264	661	1200	1110	500	21	11,39	24,38	WGDLF054122	
640	820	50	-	600	-	986	514	1000	710	600	21	8,80	18,89	WGDLF064082	
640	1020	50	-	600	-	1233	644	1200	910	600	21	10,99	23,55	WGDLF064102	
640	1220	50	-	600	-	1458	760	1500	1110	600	21	13,19	28,22	WGDLF064122	
1800	500	50	460	-	500	1403	717	-	360	1760	21	13,61	29,25	WGDLF180050	
1800	580	50	540	-	580	1623	830	-	440	1760	21	15,87	34,09	WGDLF180058	
2000	500	50	460	-	500	1556	802	-	360	1960	21	15,04	32,32	WGDLF200050	
2000	580	50	540	-	580	1774	909	-	440	1960	21	17,55	37,67	WGDLF200058	



Colour included
in the price

Available sizes:

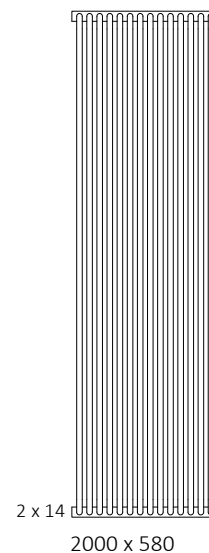
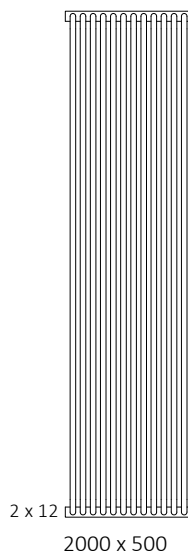
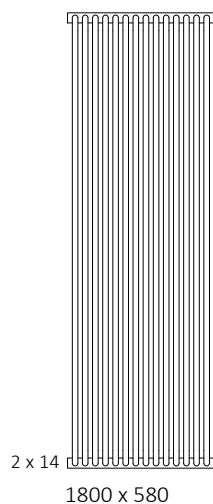
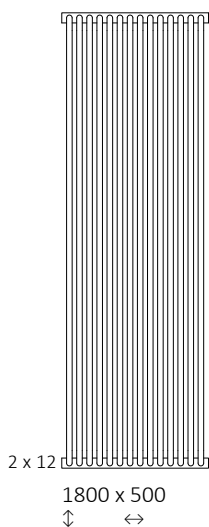
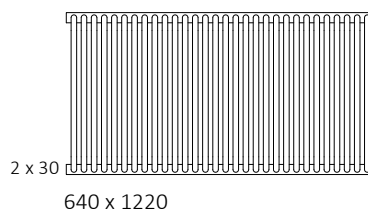
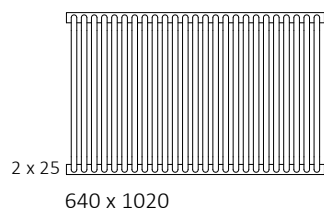
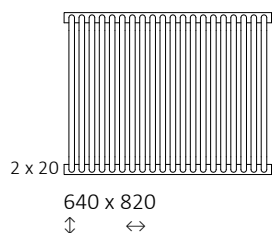
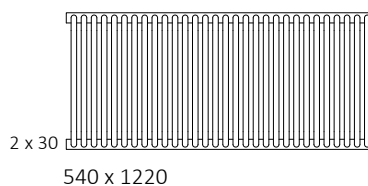
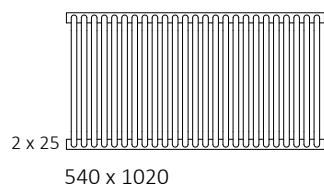
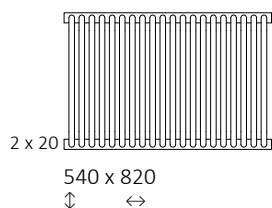
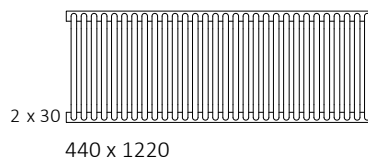
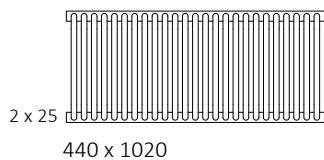
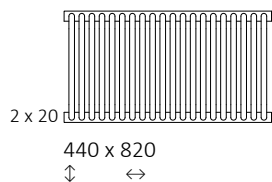

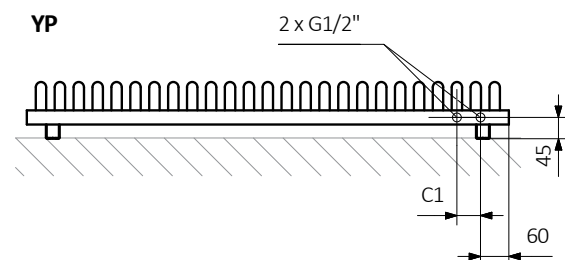
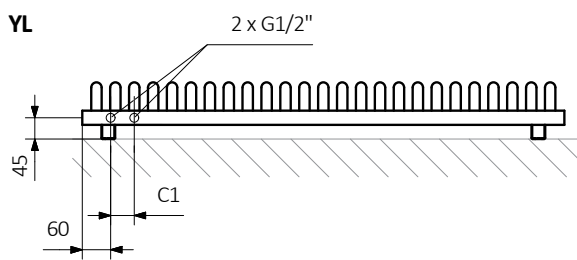
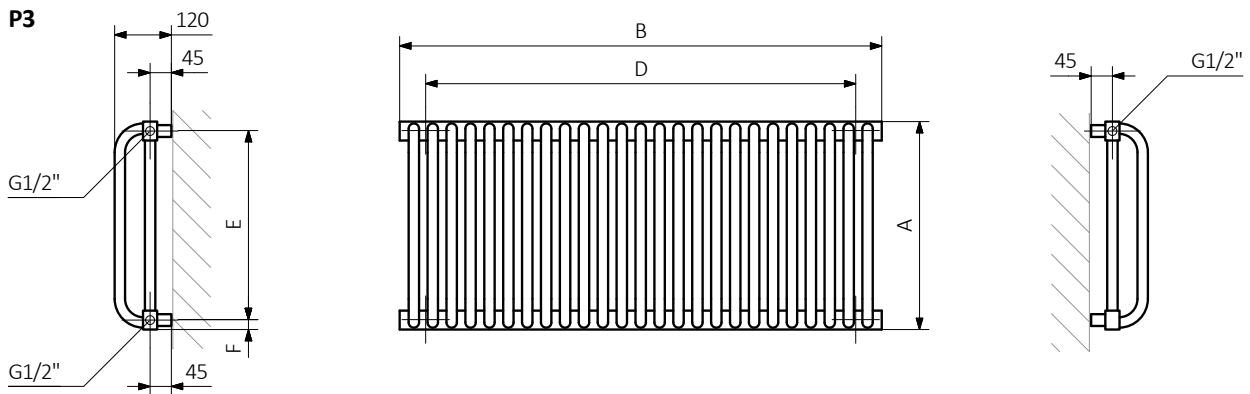
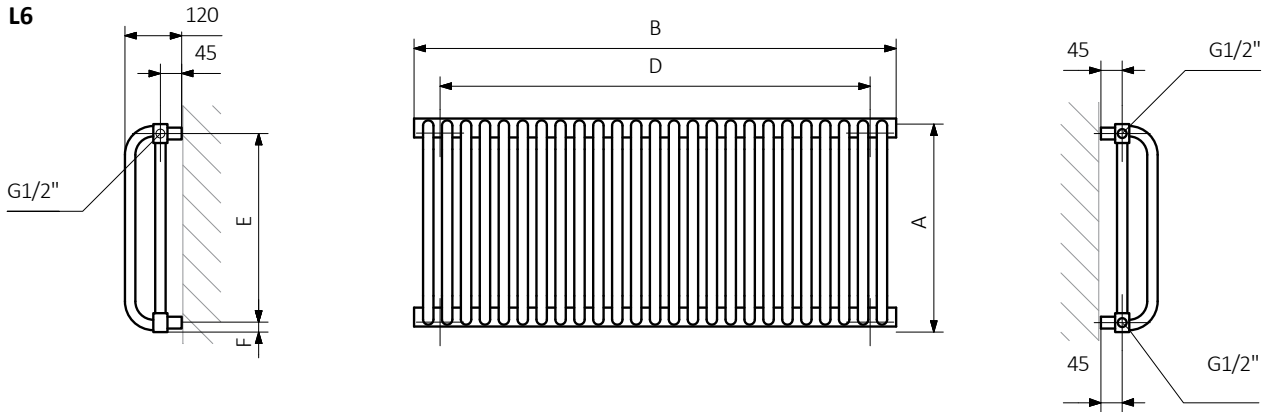

A — Height B — Width C1-C5 — Distance between pipe centres D — Horizontal distance between mounting bracket centres
E — Vertical distance between mounting brackets F — Distance between a mounting bracket and the bottom of the radiator

Collector:

Profile:

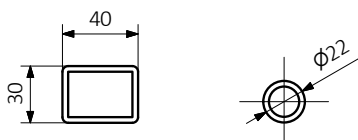



Colour included
in the price

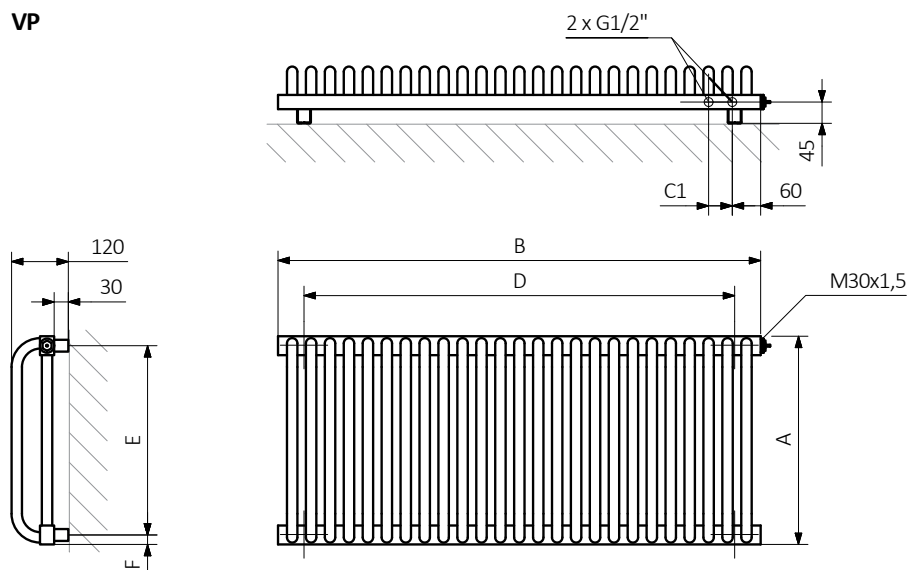
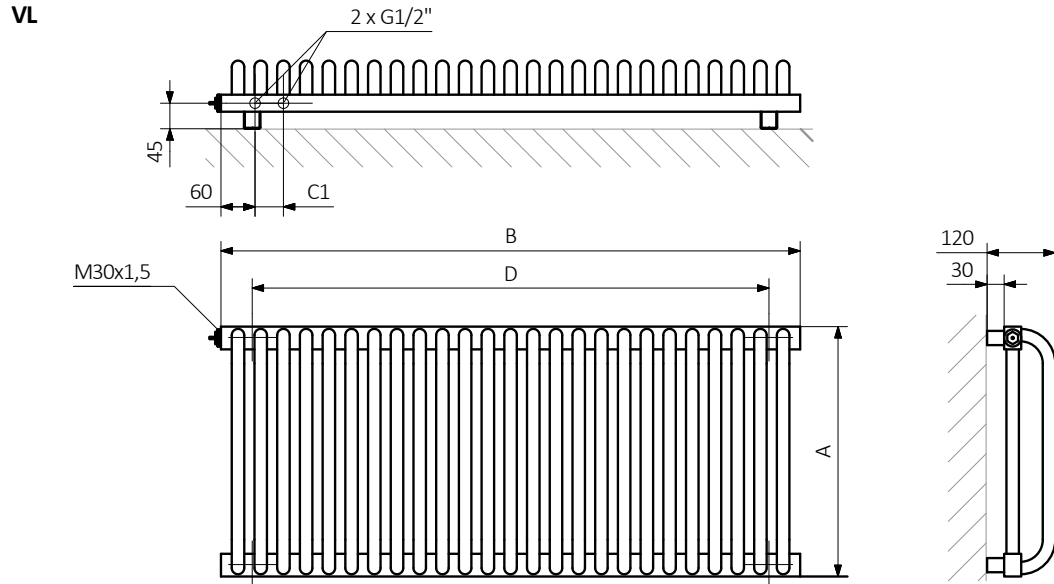

A — Height B — Width C1-C5 — Distance between pipe centres D — Horizontal distance between mounting bracket centres
E — Vertical distance between mounting brackets F — Distance between a mounting bracket and the bottom of the radiator

Collector:

Profile:

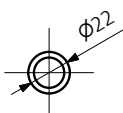
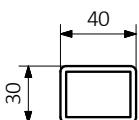



Colour included
in the price

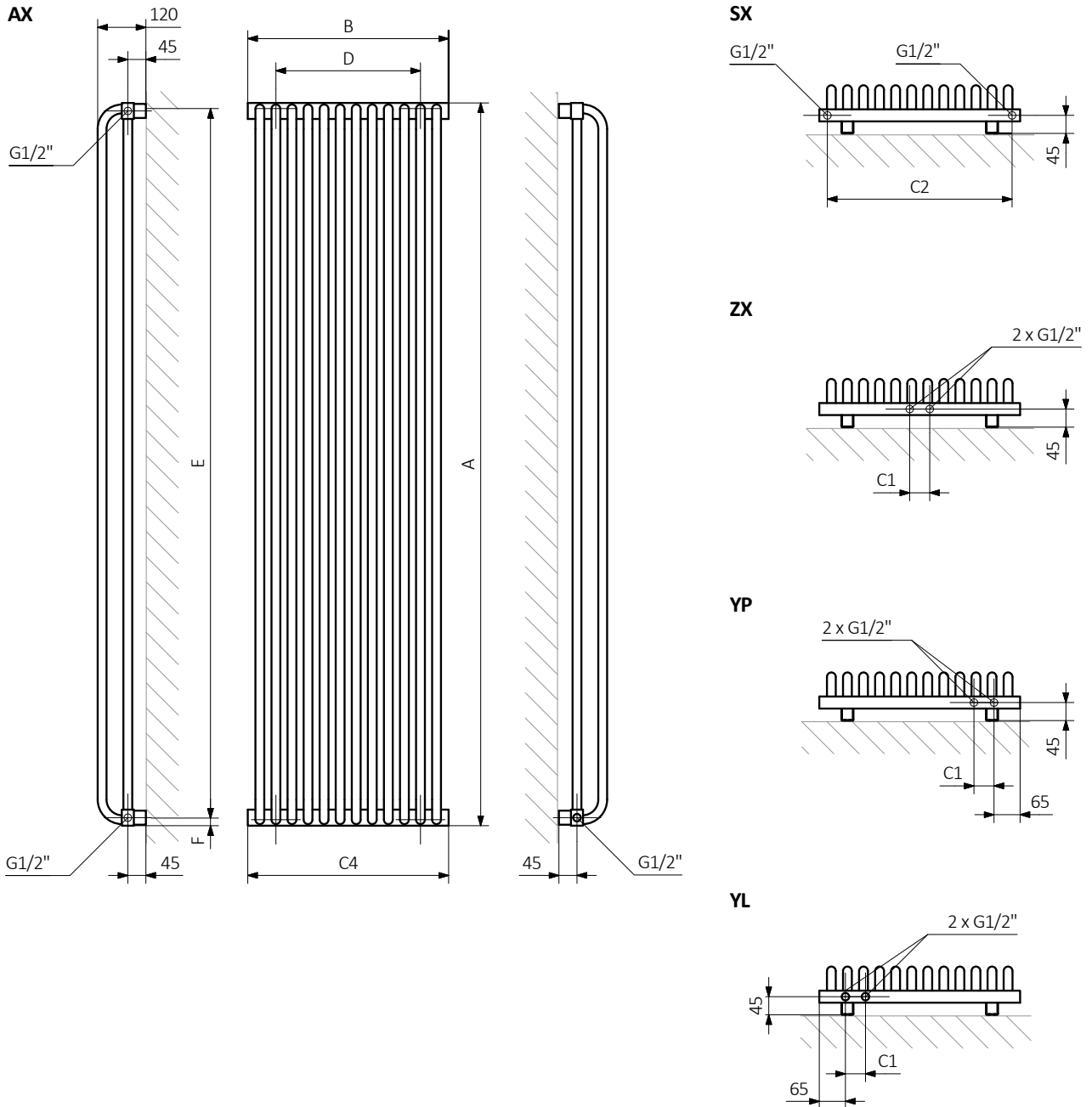

A — Height B — Width C1-C5 — Distance between pipe centres D — Horizontal distance between mounting bracket centres
E — Vertical distance between mounting brackets F — Distance between a mounting bracket and the bottom of the radiator

Collector:

Profile:

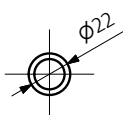
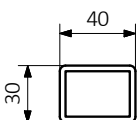



Colour included
in the price

Product codes can be found in product data sheet tables. The codes provide some basic information about the product while a partially filled configuration code contains complementary information about the detailed specifications. When placing an order, product codes should include the fully completed configuration part. The configuration code part should be placed after the main product code. The main product code and configuration part will appear as shown in the example below:

The construction of a water and dual fuel radiator product and configuration code:

WGALE054030

K916SX

PRODUCT CODE
(located in the table for the product)

CONFIGURATION CODE
(supplemented by hand)

Configuration

K **916** **SX**

Package code Colour code Connection code
K – carton box

Construction of electric heater configuration code

WLALE054030

K916E1DRYM

PRODUCT CODE
(located in the table for the product)

CONFIGURATION CODE
(supplemented by hand)

Configuration

K **916** **E1** **DRY** **M**

Package code Colour code Connection code Heating element code Type of heating element cable code
K – carton box

Zinc powder primer

C – Code of zinc powder primer is an extra processes

WLALE054030 K916SX **C** — *Extra processes or additions code*



 Colour included in the price

Legend



Available in chrome finish.



Radiator available in a "water" version.



Radiator suitable for dual fuel connection. Electric heating element can be installed.



Radiator available in electric only version. It comes prefilled with a 'heating medium' and equipped with a heating element. All tested and ready to use.



Connection types dedicated for this radiator.
The icon shows the flow and return connections for the radiator as well as the thermostatic valve and heating element position if applicable.



Optional connections available for this radiator.



Suggested heating element power output for electric and dual fuel versions.



Weight.



Capacity.